

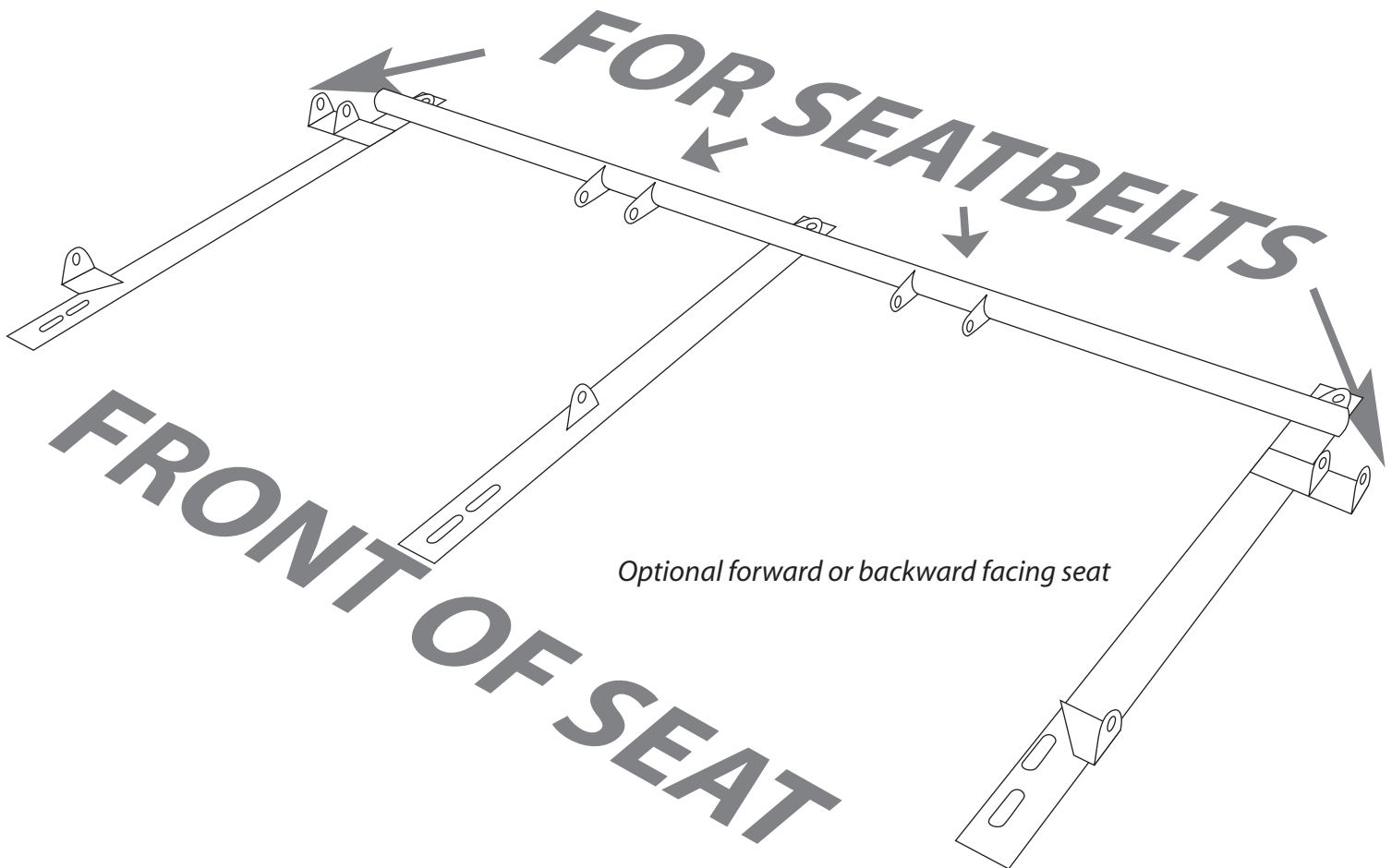

Polaris RANGER

Rear Bench Seat Installation

Part # 59969



Hardware Included

Bracket Hardware

- 6 - 1 1/4" x 5/16" bolts
- 12 - 5/16" flatwashers
- 6 - 5/16" nylock nuts

Bench Seat Hardware

- 3 - 2 1/2" x 3/8" bolts
- 2 - 1 1/4" x 3/8" bolts
- 2 - 1 x 3/8" spacers
- 5 - 3/8" flatwashers
- 5 - 3/8" nylock nuts

Tools Required

- 1/2" deepwell socket, 3/8" drive
- 9/16" deepwell socket, 3/8" drive
- 1/2" end wrench
- 9/16" end wrench
- 5/16" drill bit (min. 3" long)
- drill motor
- ratchet, 3/8" drive

Ranger Rear Seat Mount Installation

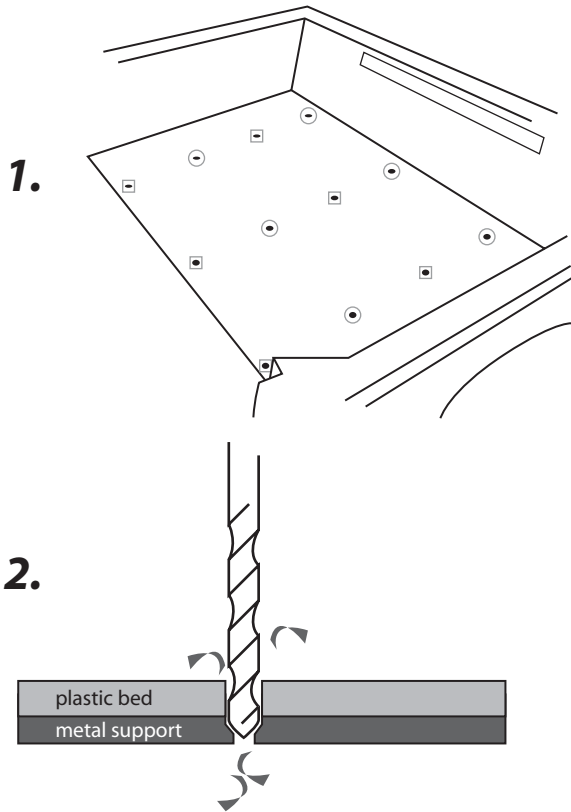

1. Remove factory bolts to face bench seat forward and factory bolts to face bench seat backward.

2. Drill out factory holes, using $5/16''$ drill bit, through inside steel bed liner.

3. Attach the three brackets to cross-member bar using three $1\ 1/4'' \times 5/16''$ bolts on the three rear tabs of cross-member. Include a $5/16''$ flatwasher under bolt head, then install bracket (fully assembled) to bed, making sure to include a $5/16''$ flatwasher under the nut to the frame and tighten with $5/16''$ nylock nut on bottom of bolt. Then, install three $1\ 1/4'' \times 5/16''$ bolts on the front of the bracket. Make sure that you include a $5/16''$ flatwasher under bolt head and under the nut to the frame, then tighten with $5/16''$ nylock nut on bottom of bolt (Diagram A).

4. Install bench seat to bracket with three $1\ 1/4'' \times 3/8''$ bolts, $3/8''$ flatwashers, and $3/8''$ nylock nuts to the three front tabs of the mounting bracket (Diagram B). Install two $2\ 1/2'' \times 3/8''$ bolts, $1 \times 3/8''$ spacers, $3/8''$ flatwashers, and $3/8''$ nylock nuts to the two rear seatbelt/bench tabs on either side of the mounting bracket (Diagram C). Refer to **fig. 1** for proper installation of Diagram C.

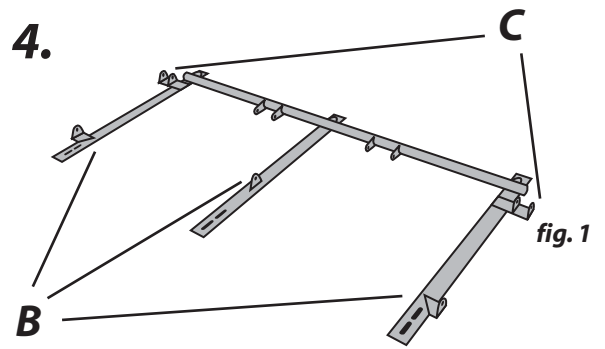
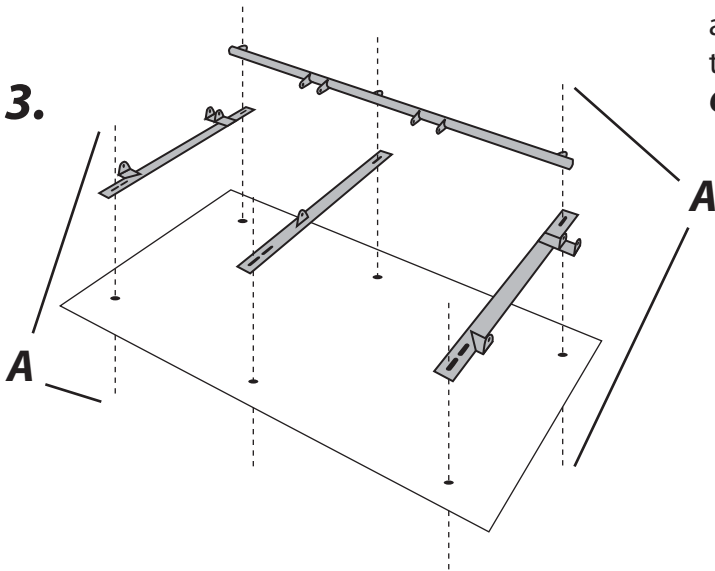

Diagrams

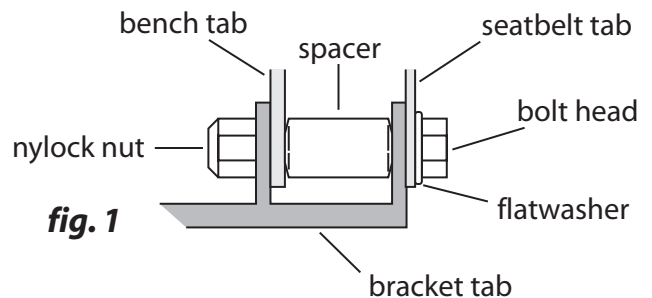
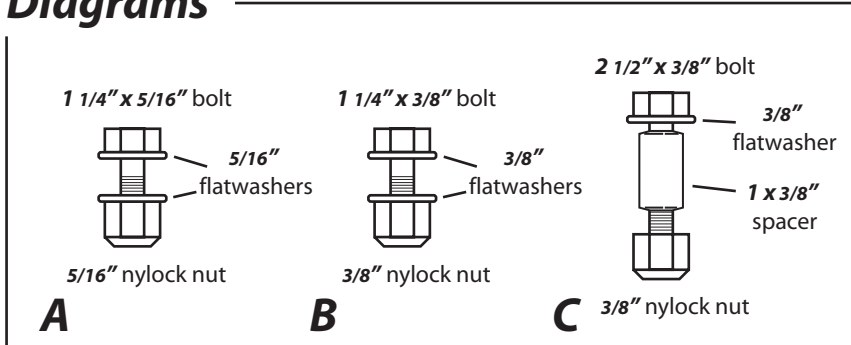

MUST BE USED IN CONJUNCTION WITH A REAR ROLL CAGE AND SAFETY HARNESS!